

Memorandum to the City of Markham Committee of Adjustment

May 31, 2021

File: A/040/21
Address: 85 Citizen Court – Markham, ON
Applicant: Humbold Properties Inc.
Agent: Pound and Stewart Planning Consultants
Hearing Date: June 9, 2021

The following comments are provided on behalf of the Central Team. The applicant is requesting relief under By-law 108-81, as amended, as it relates to proposed accessory retail sales in support of a primary business, including warehouse, distribution, and the repair of personal mobility devices. The requested variance is to permit:

a) By-law 108-81, Sec. 4.3.8:

accessory retail sales, whereas the By-law prohibits retail sales.

BACKGROUND

Property Description

The 3.66 ac (14,829.0 m²) subject property is located on the south side of Citizen Court, north of 14th Avenue, east of Birchmount Road, and west of Kennedy Road. The subject property is developed with two separate multi-unit buildings, one of which fronts onto Citizen Court (the “subject building”), and the other of which fronts onto 14th Avenue (municipally known as 4118 14th Avenue).

The property is located within an employment area primarily comprised of industrial, office, servicing, and limited commercial uses.

Proposal

The applicant is proposing to permit retail sales as an accessory use located within Units 9 and 10 of the subject building. Cumulatively, these units have an approximate gross floor area (GFA) of 765.0 m² (8,234.39 ft²). The applicant is proposing that the accessory retail use component comprises of approximately 112.49 m² (1,210.83 ft²), or 14.70% of the total GFA of the two subject units.

Official Plan and Zoning

Official Plan 2014 (partially approved on Nov 24/17, and further updated on April 9/18)

The Official Plan designates the subject property “General Employment”, which provides for a mix of single and multi-unit industrial buildings with manufacturing, processing or warehousing as primary uses.

The Official Plan is specific in restricting accessory and ancillary uses to uses that directly support primary industrial uses (manufacturing, processing, or warehousing uses) of this designation, provided specific criteria are met. Areas designated “General Employment” are to be protected from incompatible sensitive land uses, and other non-industrial uses. While retail uses are a non-industrial use, the “General Employment” designation specifically provides for retail and, or service uses, provided that these uses:

- are accessory to the primary manufacturing, processing, or warehousing use;

- are located in the same premise as the primary use; and
- do not exceed 500.0 m² (5,381.96 ft²) of GFA, or a maximum of 15.0% of the total GFA devoted to the primary use, whichever is less.

Zoning By-Law 108-81

The subject property is split zoned “Select Industrial and Limited Commercial – M.C. (40%)”, and “Select Industrial and Limited Commercial – M.C. (60%)” under By-law 108-81, as amended. The subject building is located entirely within the area zoned “Select Industrial and Limited Commercial – M.C. (40%)”, which permits the following uses:

- Commercial – Banks and financial institutions chartered under the laws of Canada;
- Professional and Business Offices;
- Commercial Schools;
- Hotels;
- Motels; and
- all uses permitted in Section 7.1.1 (M Zone), which includes the warehousing of goods and materials; and repair and servicing of goods.

Retail sales are prohibited, except where specifically permitted by the By-law. The M.C. (40%) zone only permits retail stores and personal service shops as accessory uses to office buildings, hotels, or motels, with retail being limited to include the sale of convenience goods such as newspapers, magazines, tobacco products, and candy.

Previous Minor Variance Applications

According to City records, the Committee of Adjustment (“the Committee”) previously approved minor variance applications on the subject lands on two separate occasions, which are detailed as follows:

- In 1998, the Committee approved a minor variance application (A/28/98) to reduce the minimum landscape strip from 9.0 m (29.53 ft) to 7.0 m (22.97 ft), in order to permit the construction of a new industrial-commercial building; and
- In 1999, the Committee approved a minor variance application (A/104/99) to reduce the number of parking spaces required from 142 to 134 parking spaces, in order to permit Units 9 & 10 to be leased as office space.

Zoning Preliminary Review (ZPR) Not Undertaken

The applicant has confirmed that a ZPR has not been conducted. It is the applicant’s responsibility to ensure that the application has accurately identified any non-compliances with the Zoning By-law required for the proposed development. If the variance request in this application contains errors, or if the need for additional variances is identified during the Building Permit review process, further variance application(s) may be required.

COMMENTS

The *Planning Act, R.S.O. 1990, c. P.13, as amended*, states that four tests must be met in order for a variance to be granted by the Committee:

- a) The variance must be minor in nature;
- b) The variance must be desirable, in the opinion of the Committee, for the appropriate development or use of land, building or structure;
- c) The general intent and purpose of the Zoning By-law must be maintained;
- d) The general intent and purpose of the Official Plan must be maintained.

Accessory Retail Use

The applicant is requesting to permit accessory retail sales, whereas the By-law prohibits retail sales. The applicant submits that the proposed accessory retail use would support the primary industrial use and planned function of the property by providing space to allow customers to view and experience accessory products for their mobility devices before considering them for purchase. According to the floor plan, the proposed accessory retail sales use would be accessed by the main entry doors located at the front of the subject units, whereas the primary industrial (warehousing) use would be located at the back. Other uses include office space, and an assessment area in the middle of the subject units. The requested 14.70% of the units total GFA being dedicated to accessory retail sales would not exceed the maximum GFA as provided for in the Official Plan. The applicant submits that the larger floor space proposed to be dedicated to accessory retail sales is to provide for a safe and accessible floor space that would support maneuverability for customers and clientele of varying abilities.

PUBLIC INPUT SUMMARY

No written submissions were received as of June 31, 2021. It is noted that additional information may be received after the writing of the report, and the Secretary-Treasurer will provide information on this at the meeting.

CONCLUSION

Planning staff have reviewed the application with respect to the four tests under Section 45(1) of the *Planning Act*. In consideration of the applicant's submission that the proposed retail use is an accessory component to the primary industrial function, staff do not anticipate that the use would adversely impact the planned function, as provided for in the Official Plan. However, staff note that the By-law currently in effect does prohibit retail stores. Staff recommend that the Committee satisfy themselves that the four tests of the *Planning Act* are met, and that public input be considered in reaching a decision. Should the Committee choose to approve the application, staff recommend that any approval be subject to those conditions detailed in Appendix "A".

The onus is ultimately on the applicant to demonstrate why they should be granted relief from the requirements of the By-law, and how they satisfy the tests of the *Planning Act* required for the granting of minor variances.

APPENDICES

Appendix "A" – Conditions of Approval

Appendix "B" – Plans

PREPARED BY:

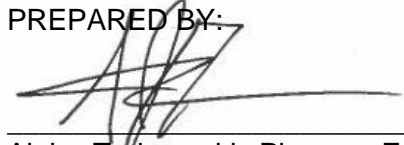

Aleks Todorovski, Planner, Zoning and Special Projects

REVIEWED BY:

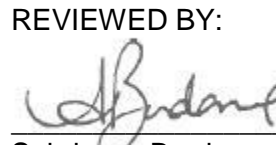

Sabrina Bordone, Senior Planner, Central District

APPENDIX "A"**CONDITIONS TO BE ATTACHED TO ANY APPROVAL OF FILE A/040/21**

1. That the accessory retail use only be permitted up to a maximum of 114.75 m² (1,235.16 ft²), or 15.0% gross floor area of the subject Units 9 & 10 for as long as the accessory use, and, or units remain.
2. That the variance applies only to the subject development, in substantial conformity with the batch stamped plans attached as Appendix "B" to this Staff Report, and that the Secretary-Treasurer receive written confirmation from the Director of Planning and Urban Design or designate that this condition has been fulfilled to his or her satisfaction.

CONDITIONS PREPARED BY:

A handwritten signature in black ink, appearing to read 'Aleks Todorovski', is written over a horizontal line.

Aleks Todorovski, Planner, Zoning and Special Projects

APPENDIX “B”

PLANS TO BE ATTACHED TO ANY APPROVAL OF FILE A/040/21

MM/DD/YY

control or to
check and verify
all dimensions
on job site

revision

no.	description	date	by

1

100

1. The first step in the process is to identify the problem or issue that needs to be addressed. This involves gathering information and understanding the context of the problem.

LINE 100		JTE BLANK APP. WATER KEY LOCAL
----------	--	---

DATE		
MAN TO DO		TURNING RADIUS

MAR 10 89		21 PENDING
MAR 6 89	●	FINAL

[illegible]

Developer	Contractor	Applicant
-----------	------------	-----------

ner/dev	ment	ermit	neral co	nder	the plan
---------	------	-------	----------	------	----------

10	11	12	13	14	15	16	17	18	19	20	21	22	23	24	25	26	27	28	29	30	31	32	33	34	35	36	37	38	39	40	41	42	43	44	45	46	47	48	49	50	51	52	53	54	55	56	57	58	59	60	61	62	63	64	65	66	67	68	69	70	71	72	73	74	75	76	77	78	79	80	81	82	83	84	85	86	87	88	89	90	91	92	93	94	95	96	97	98	99	100	101	102	103	104	105	106	107	108	109	110	111	112	113	114	115	116	117	118	119	120	121	122	123	124	125	126	127	128	129	130	131	132	133	134	135	136	137	138	139	140	141	142	143	144	145	146	147	148	149	150	151	152	153	154	155	156	157	158	159	160	161	162	163	164	165	166	167	168	169	170	171	172	173	174	175	176	177	178	179	180	181	182	183	184	185	186	187	188	189	190	191	192	193	194	195	196	197	198	199	200	201	202	203	204	205	206	207	208	209	210	211	212	213	214	215	216	217	218	219	220	221	222	223	224	225	226	227	228	229	230	231	232	233	234	235	236	237	238	239	240	241	242	243	244	245	246	247	248	249	250	251	252	253	254	255	256	257	258	259	260	261	262	263	264	265	266	267	268	269	270	271	272	273	274	275	276	277	278	279	280	281	282	283	284	285	286	287	288	289	290	291	292	293	294	295	296	297	298	299	300	301	302	303	304	305	306	307	308	309	310	311	312	313	314	315	316	317	318	319	320	321	322	323	324	325	326	327	328	329	330	331	332	333	334	335	336	337	338	339	340	341	342	343	344	345	346	347	348	349	350	351	352	353	354	355	356	357	358	359	360	361	362	363	364	365	366	367	368	369	370	371	372	373	374	375	376	377	378	379	380	381	382	383	384	385	386	387	388	389	390	391	392	393	394	395	396	397	398	399	400	401	402	403	404	405	406	407	408	409	410	411	412	413	414	415	416	417	418	419	420	421	422	423	424	425	426	427	428	429	430	431	432	433	434	435	436	437	438	439	440	441	442	443	444	445	446	447	448	449	450	451	452	453	454	455	456	457	458	459	460	461	462	463	464	465	466	467	468	469	470	471	472	473
----	----	----	----	----	----	----	----	----	----	----	----	----	----	----	----	----	----	----	----	----	----	----	----	----	----	----	----	----	----	----	----	----	----	----	----	----	----	----	----	----	----	----	----	----	----	----	----	----	----	----	----	----	----	----	----	----	----	----	----	----	----	----	----	----	----	----	----	----	----	----	----	----	----	----	----	----	----	----	----	----	----	----	----	----	----	----	----	----	----	-----	-----	-----	-----	-----	-----	-----	-----	-----	-----	-----	-----	-----	-----	-----	-----	-----	-----	-----	-----	-----	-----	-----	-----	-----	-----	-----	-----	-----	-----	-----	-----	-----	-----	-----	-----	-----	-----	-----	-----	-----	-----	-----	-----	-----	-----	-----	-----	-----	-----	-----	-----	-----	-----	-----	-----	-----	-----	-----	-----	-----	-----	-----	-----	-----	-----	-----	-----	-----	-----	-----	-----	-----	-----	-----	-----	-----	-----	-----	-----	-----	-----	-----	-----	-----	-----	-----	-----	-----	-----	-----	-----	-----	-----	-----	-----	-----	-----	-----	-----	-----	-----	-----	-----	-----	-----	-----	-----	-----	-----	-----	-----	-----	-----	-----	-----	-----	-----	-----	-----	-----	-----	-----	-----	-----	-----	-----	-----	-----	-----	-----	-----	-----	-----	-----	-----	-----	-----	-----	-----	-----	-----	-----	-----	-----	-----	-----	-----	-----	-----	-----	-----	-----	-----	-----	-----	-----	-----	-----	-----	-----	-----	-----	-----	-----	-----	-----	-----	-----	-----	-----	-----	-----	-----	-----	-----	-----	-----	-----	-----	-----	-----	-----	-----	-----	-----	-----	-----	-----	-----	-----	-----	-----	-----	-----	-----	-----	-----	-----	-----	-----	-----	-----	-----	-----	-----	-----	-----	-----	-----	-----	-----	-----	-----	-----	-----	-----	-----	-----	-----	-----	-----	-----	-----	-----	-----	-----	-----	-----	-----	-----	-----	-----	-----	-----	-----	-----	-----	-----	-----	-----	-----	-----	-----	-----	-----	-----	-----	-----	-----	-----	-----	-----	-----	-----	-----	-----	-----	-----	-----	-----	-----	-----	-----	-----	-----	-----	-----	-----	-----	-----	-----	-----	-----	-----	-----	-----	-----	-----	-----	-----	-----	-----	-----	-----	-----	-----	-----	-----	-----	-----	-----	-----	-----	-----	-----	-----	-----	-----	-----	-----	-----	-----	-----	-----	-----	-----	-----	-----	-----	-----	-----	-----	-----	-----	-----	-----	-----	-----	-----	-----	-----	-----	-----	-----	-----	-----	-----	-----	-----	-----	-----	-----	-----	-----	-----	-----	-----	-----	-----	-----	-----	-----	-----	-----	-----	-----	-----	-----	-----	-----	-----	-----	-----	-----	-----	-----	-----	-----	-----	-----	-----	-----	-----	-----	-----	-----	-----	-----	-----	-----	-----	-----	-----

1	2	3	4	5	6	7	8	9	10	11	12	13	14	15	16	17	18	19	20	21	22	23	24	25	26	27	28	29	30	31	32	33	34	35	36	37	38	39	40	41	42	43	44	45	46	47	48	49	50	51	52	53	54	55	56	57	58	59	60	61	62	63	64	65	66	67	68	69	70	71	72	73	74	75	76	77	78	79	80	81	82	83	84	85	86	87	88	89	90	91	92	93	94	95	96	97	98	99	100	101	102	103	104	105	106	107	108	109	110	111	112	113	114	115	116	117	118	119	120	121	122	123	124	125	126	127	128	129	130	131	132	133	134	135	136	137	138	139	140	141	142	143	144	145	146	147	148	149	150	151	152	153	154	155	156	157	158	159	160	161	162	163	164	165	166	167	168	169	170	171	172	173	174	175	176	177	178	179	180	181	182	183	184	185	186	187	188	189	190	191	192	193	194	195	196	197	198	199	200	201	202	203	204	205	206	207	208	209	210	211	212	213	214	215	216	217	218	219	220	221	222	223	224	225	226	227	228	229	230	231	232	233	234	235	236	237	238	239	240	241	242	243	244	245	246	247	248	249	250	251	252	253	254	255	256	257	258	259	260	261	262	263	264	265	266	267	268	269	270	271	272	273	274	275	276	277	278	279	280	281	282	283	284	285	286	287	288	289	290	291	292	293	294	295	296	297	298	299	300	301	302	303	304	305	306	307	308	309	310	311	312	313	314	315	316	317	318	319	320	321	322	323	324	325	326	327	328	329	330	331	332	333	334	335	336	337	338	339	340	341	342	343	344	345	346	347	348	349	350	351	352	353	354	355	356	357	358	359	360	361	362	363	364	365	366	367	368	369	370	371	372	373	374	375	376	377	378	379	380	381	382	383	384	385	386	387	388	389	390	391	392	393	394	395	396	397	398	399	400	401	402	403	404	405	406	407	408	409	410	411	412	413	414	415	416	417	418	419	420	421	422	423	424	425	426	427	428	429	430	431	432	433	434	435	436	437	438	439	440	441	442	443	444	445	446	447	448	449	450	451	452	453	454	455	456	457	458	459	460	461	462	463	464	465	466
---	---	---	---	---	---	---	---	---	----	----	----	----	----	----	----	----	----	----	----	----	----	----	----	----	----	----	----	----	----	----	----	----	----	----	----	----	----	----	----	----	----	----	----	----	----	----	----	----	----	----	----	----	----	----	----	----	----	----	----	----	----	----	----	----	----	----	----	----	----	----	----	----	----	----	----	----	----	----	----	----	----	----	----	----	----	----	----	----	----	----	----	----	----	----	----	----	----	----	-----	-----	-----	-----	-----	-----	-----	-----	-----	-----	-----	-----	-----	-----	-----	-----	-----	-----	-----	-----	-----	-----	-----	-----	-----	-----	-----	-----	-----	-----	-----	-----	-----	-----	-----	-----	-----	-----	-----	-----	-----	-----	-----	-----	-----	-----	-----	-----	-----	-----	-----	-----	-----	-----	-----	-----	-----	-----	-----	-----	-----	-----	-----	-----	-----	-----	-----	-----	-----	-----	-----	-----	-----	-----	-----	-----	-----	-----	-----	-----	-----	-----	-----	-----	-----	-----	-----	-----	-----	-----	-----	-----	-----	-----	-----	-----	-----	-----	-----	-----	-----	-----	-----	-----	-----	-----	-----	-----	-----	-----	-----	-----	-----	-----	-----	-----	-----	-----	-----	-----	-----	-----	-----	-----	-----	-----	-----	-----	-----	-----	-----	-----	-----	-----	-----	-----	-----	-----	-----	-----	-----	-----	-----	-----	-----	-----	-----	-----	-----	-----	-----	-----	-----	-----	-----	-----	-----	-----	-----	-----	-----	-----	-----	-----	-----	-----	-----	-----	-----	-----	-----	-----	-----	-----	-----	-----	-----	-----	-----	-----	-----	-----	-----	-----	-----	-----	-----	-----	-----	-----	-----	-----	-----	-----	-----	-----	-----	-----	-----	-----	-----	-----	-----	-----	-----	-----	-----	-----	-----	-----	-----	-----	-----	-----	-----	-----	-----	-----	-----	-----	-----	-----	-----	-----	-----	-----	-----	-----	-----	-----	-----	-----	-----	-----	-----	-----	-----	-----	-----	-----	-----	-----	-----	-----	-----	-----	-----	-----	-----	-----	-----	-----	-----	-----	-----	-----	-----	-----	-----	-----	-----	-----	-----	-----	-----	-----	-----	-----	-----	-----	-----	-----	-----	-----	-----	-----	-----	-----	-----	-----	-----	-----	-----	-----	-----	-----	-----	-----	-----	-----	-----	-----	-----	-----	-----	-----	-----	-----	-----	-----	-----	-----	-----	-----	-----	-----	-----	-----	-----	-----	-----	-----	-----	-----	-----	-----	-----	-----	-----	-----	-----	-----	-----	-----	-----	-----	-----	-----	-----	-----	-----	-----	-----	-----	-----	-----	-----	-----	-----	-----	-----	-----	-----	-----	-----	-----	-----	-----	-----	-----	-----	-----	-----	-----	-----	-----	-----	-----	-----	-----	-----	-----	-----	-----	-----	-----	-----

1000

1

1. *Chlorophyll a* (Chl *a*)

100

--	--

100

100

1997, 1998, 1999, 2000, 2001, 2002, 2003, 2004, 2005, 2006, 2007, 2008, 2009, 2010, 2011, 2012, 2013, 2014, 2015, 2016, 2017, 2018, 2019, 2020, 2021, 2022, 2023, 2024, 2025, 2026, 2027, 2028, 2029, 2030, 2031, 2032, 2033, 2034, 2035, 2036, 2037, 2038, 2039, 2040, 2041, 2042, 2043, 2044, 2045, 2046, 2047, 2048, 2049, 2050, 2051, 2052, 2053, 2054, 2055, 2056, 2057, 2058, 2059, 2060, 2061, 2062, 2063, 2064, 2065, 2066, 2067, 2068, 2069, 2070, 2071, 2072, 2073, 2074, 2075, 2076, 2077, 2078, 2079, 2080, 2081, 2082, 2083, 2084, 2085, 2086, 2087, 2088, 2089, 2090, 2091, 2092, 2093, 2094, 2095, 2096, 2097, 2098, 2099, 2100, 2101, 2102, 2103, 2104, 2105, 2106, 2107, 2108, 2109, 2110, 2111, 2112, 2113, 2114, 2115, 2116, 2117, 2118, 2119, 2120, 2121, 2122, 2123, 2124, 2125, 2126, 2127, 2128, 2129, 2130, 2131, 2132, 2133, 2134, 2135, 2136, 2137, 2138, 2139, 2140, 2141, 2142, 2143, 2144, 2145, 2146, 2147, 2148, 2149, 2150, 2151, 2152, 2153, 2154, 2155, 2156, 2157, 2158, 2159, 2160, 2161, 2162, 2163, 2164, 2165, 2166, 2167, 2168, 2169, 2170, 2171, 2172, 2173, 2174, 2175, 2176, 2177, 2178, 2179, 2180, 2181, 2182, 2183, 2184, 2185, 2186, 2187, 2188, 2189, 2190, 2191, 2192, 2193, 2194, 2195, 2196, 2197, 2198, 2199, 2200, 2201, 2202, 2203, 2204, 2205, 2206, 2207, 2208, 2209, 2210, 2211, 2212, 2213, 2214, 2215, 2216, 2217, 2218, 2219, 2220, 2221, 2222, 2223, 2224, 2225, 2226, 2227, 2228, 2229, 2230, 2231, 2232, 2233, 2234, 2235, 2236, 2237, 2238, 2239, 2240, 2241, 2242, 2243, 2244, 2245, 2246, 2247, 2248, 2249, 2250, 2251, 2252, 2253, 2254, 2255, 2256, 2257, 2258, 2259, 2260, 2261, 2262, 2263, 2264, 2265, 2266, 2267, 2268, 2269, 2270, 2271, 2272, 2273, 2274, 2275, 2276, 2277, 2278, 2279, 2280, 2281, 2282, 2283, 2284, 2285, 2286, 2287, 2288, 2289, 2290, 2291, 2292, 2293, 2294, 2295, 2296, 2297, 2298, 2299, 2300, 2301, 2302, 2303, 2304, 2305, 2306, 2307, 2308, 2309, 2310, 2311, 2312, 2313, 2314, 2315, 2316, 2317, 2318, 2319, 2320, 2321, 2322, 2323, 2324, 2325, 2326, 2327, 2328, 2329, 2330, 2331, 2332, 2333, 2334, 2335, 2336, 2337, 2338, 2339, 2340, 2341, 2342, 2343, 2344, 2345, 2346, 2347, 2348, 2349, 2350, 2351, 2352, 2353, 2354, 2355, 2356, 2357, 2358, 2359, 2360, 2361, 2362, 2363, 2364, 2365, 2366, 2367, 2368, 2369, 2370, 2371, 2372, 2373, 2374, 2375, 2376, 2377, 2378, 2379, 2380, 2381, 2382, 2383, 2384, 2385, 2386, 2387, 2388, 2389, 2390, 2391, 2392, 2393, 2394, 2395, 2396, 2397, 2398, 2399, 2400, 2401, 2402, 2403, 2404, 2405, 2406, 2407, 2408, 2409, 2410, 2411, 2412, 2413, 2414, 2415, 2416, 2417, 2418, 2419, 2420, 2421, 2422, 2423, 2424, 2425, 2426, 2427, 2428, 2429, 2430, 2431, 2432, 2433, 2434, 2435, 2436, 2437, 2438, 2439, 2440, 2441, 2442, 2443, 2444, 2445, 2446, 2447, 2448, 2449, 2450, 2451, 2452, 2453, 2454, 2455, 2456, 2457, 2458, 2459, 2460, 2461, 2462, 2463, 2464, 2465, 2466, 2467, 2468, 2469, 2470, 2471, 2472, 2473, 2474, 2475, 2476, 2477, 2478, 2479, 2480, 2481, 2482, 2483, 2484, 2485, 2486, 2487, 2488, 2489, 2490, 2491, 2492, 2493, 2494, 2495, 2496, 2497, 2498, 2499, 2500, 2501, 2502, 2503, 2504, 2505, 2506, 2507, 2508, 2509, 2510, 2511, 2512, 2513, 2514, 2515, 2516, 2517, 2518, 2519, 2520, 2521, 2522, 2523, 2524, 2525, 2526, 2527, 2528, 2529, 2530, 2531, 2532, 2533, 2534, 2535, 2536, 2537, 2538, 2539, 2540, 2541, 2542, 2543, 2544, 2545, 2546, 2547, 2548, 2549, 2550, 2551, 2552, 2553, 2554, 2555, 2556, 2557, 2558, 2559, 2560, 2561, 2562, 2563, 2564, 2565, 2566, 2567, 2568, 2569, 2570, 2571, 2572, 2573, 2574, 2575, 2576, 2577, 2578, 2579, 2580, 2581, 2582, 2583, 2584, 2585, 2586, 2587, 2588, 2589, 2590, 2591, 2592, 2593, 2594, 2595, 2596, 2597, 2598, 2599, 2600, 2601, 2602, 2603, 2604, 2605, 2606, 2607, 2608, 2609, 2610, 2611, 2612, 2613, 2614, 2615, 2616, 2617, 2618, 2619, 2620, 2621, 2622, 2623, 2624, 2625, 2626, 2627, 2628, 2629, 2630, 2631, 2632, 2633, 2634, 2635, 2636, 2637, 2638, 2639, 2640, 2641, 2642, 2643, 2644, 2645, 2646, 2647, 2648, 2649, 2650, 2651, 2652, 2653, 2654, 2655, 2656, 2657, 2658, 2659, 2660, 2661, 2662, 2663, 2664, 2665, 2666, 2667, 2668, 2669, 2670, 2671, 2672, 2673, 2674, 2675, 2676, 2677, 2678, 26

[illegible]

 Dallan

Levine

179 JOHN STREET 7TH FLOOR
TORONTO, ONTARIO M5T 1X4

(416) 593-5503
FAX 593-6709

project title	start date	end date	status	priority	assigned to	progress	comments
Project A	2023-01-01	2023-03-31	Completed	High	John Doe	100%	Project A completed successfully.
Project B	2023-04-01	2023-06-30	In Progress	Medium	Jane Smith	75%	Project B is currently in progress.
Project C	2023-07-01	2023-09-30	Planned	Low	Mike Johnson	0%	Project C is planned for the future.

HUMBOLDT

PROPERTIES
LTD

SOUTH SITE
MARKHAM, ONTARIO

drawing title

PARTIAL

PARTIAL
SITE PLAN

date	scale
JUNE 1 89	1:250

drawn by	approved
----------	----------

project number	8835
----------------	------

drawing number
A-1008-R

ALL SURVEY INFORMATION TAKEN FROM PLAN OF
TOPOGRAPHIC SURVEY OF PART OF LOT 6,
CONCESSION 5, TOWN OF MARKHAM, REGIONAL
MUNICIPALITY OF YORK,
BY OTTO ERL, O. L. S.
NOVEMBER 1988, PROJECT NUMBER 88-241

ALL GEOTECHNICAL INFORMATION TO BE REFERENCED FROM
GEOTECHNICAL INVESTIGATION PREPARED BY HUMBOLD PROPERTIES
BY V.A. WOOD ASSOCIATES LIMITED REF. NO. 1514-8-10

Units 9 & 10 85 Citizen Court



4711 Yonge St.
Suite 800
Toronto, ON.
M2N 6K8
T.416.497.3662
info@glsmith.ca
www.glsmith.ca

G.L. SMITH

PROFESSIONAL STAMPS:

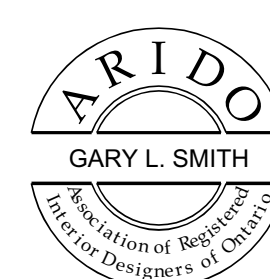

The undersigned has reviewed and takes full responsibility for this design, and has the qualifications and meets the requirements set out in the Ontario Building Code to be a designer.

QUALIFICATION INFORMATION

Required unless design is exempt under Division C - 3.2.5.1. of the 2012 Ontario Building Code (or 2.17.4.1. of the 1997 Ontario Building Code)

GARY SMITH 20949
NAME SIGNATURE SKN

REGISTRATION INFORMATION

Required unless design is exempt under Division C - 3.2.4.1. of the 2012 Ontario Building Code (or 2.17.4.1. of the 1997 Ontario Building Code)

G.L. SMITH PLANNING AND DESIGN INC. 22467
FIRM NAME SIGNATURE SKN

COPYRIGHT DISCLAIMER:

- ALL CONSTRUCTION ACTIVITIES MUST FULLY COMPLY WITH THE PROVINCIAL BUILDING CODE AS AMENDED, AND TO ALL OTHER APPLICABLE LAWS.
- ALL DRAWINGS AND SPECIFICATIONS ARE THE EXCLUSIVE PROPERTY OF THE ARCHITECT AND NO COPY AND/OR REPRODUCTION IS PERMITTED WITHOUT WRITTEN CONSENT HAS BEEN PROVIDED BY THE ARCHITECT.
- I HAVE EXERCISED RESPONSIBLE CONTROL WITH RESPECT TO DESIGN REVIEW ACTIVITIES.
- REVIEW WORK PERTAINS TO COMPLIANCE TO THE PROVINCIAL BUILDING CODE FOR ARCHITECTURAL WORK ONLY. DRAWINGS OF OTHER PROFESSIONAL ENGINEERS INCLUDING STRUCTURAL, MECHANICAL, ELECTRICAL AND OTHER PROFESSIONAL DESIGNERS MUST BE REFERENCED ACCORDINGLY.
- DRAWINGS MAY BE USED FOR CONSTRUCTION, ONLY WHEN SIGNED AND SEALED BY THE ARCHITECT.
- CONTRACTOR CANNOT COMMENCE ANY ON-SITE WORK UNLESS ALL APPLICABLE BUILDING PERMITS ARE DISPLAYED ON SITE.

ISSUE

#	Date	Description	Dwn
4	JAN 10, 2021	REISSUE FOR PERMIT	MT
3	JAN 14, 2021	ISSUED FOR CLIENT REVIEW	MT
2	DEC 21, 2020	ISSUED FOR PERMIT	MT
1	DEC 10, 2020	ISSUED FOR CLIENT REVIEW	MT

PROJECT TITLE:

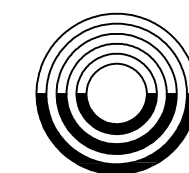

MOTION

85 CITIZEN COURT
MARKHAM, ON
L6G 1A8
CRU 9-10

REVISION

#	Date	Description	Dwn
3	APRIL 12, 2021	REV SQFT AS PER CLIENT EQUEST	MT
2	MAR 9, 2021	REVISED PER PERMIT COMMENT	EW
1	JAN 14, 2021	REVISED PER LANDLORD COMMENTS	EW

DRAWING TITLE:

FIXTURE PLAN

PRINT DATE: 12-Apr-21 SCALE: AS NOTED

DRAWN BY: EW DRAWING NO:

CHECKED BY: MT

PROJECT NO: 20-1053

A7.0

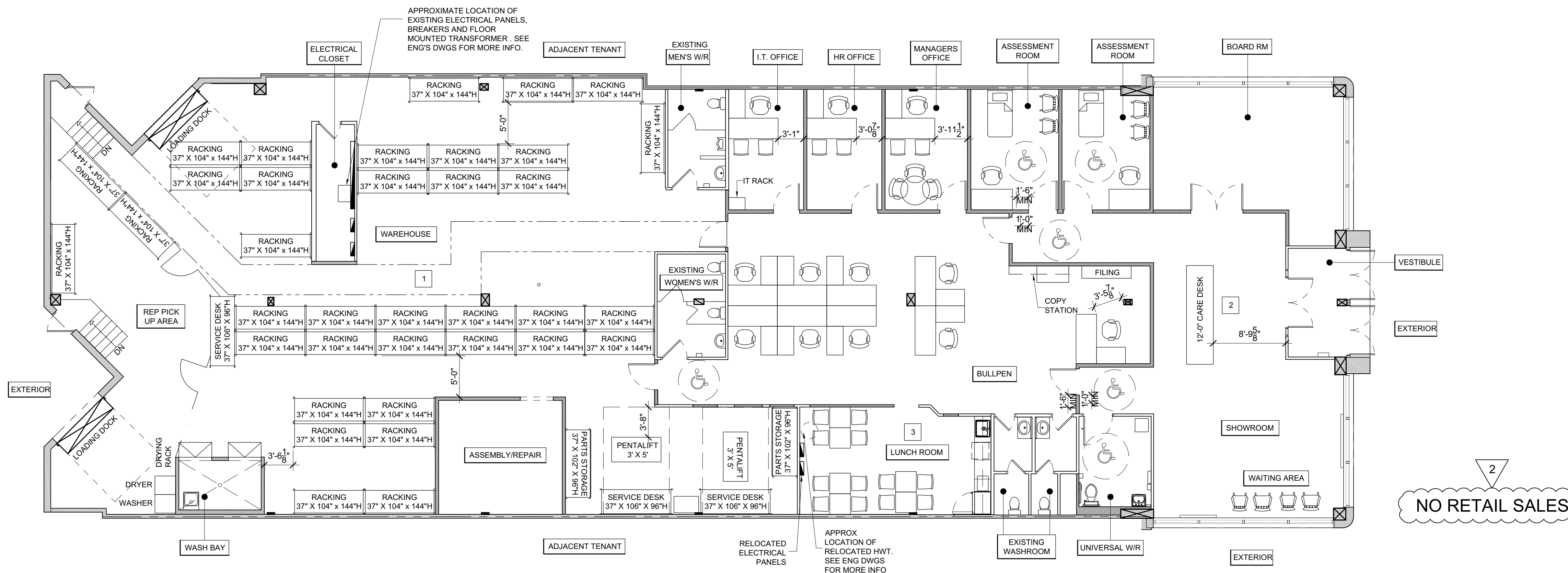

A
7.0
FIXTURE PLAN
SCALE: 1/8"=1'-0"

AREA CALCULATIONS

AREA	SQ. FT	SQ. M	%
PRIVATE BOARDROOM	440.42 FT²	40.91	5%
PRIVATE ASSESSMENT ROOM	332.5 FT²	30.89	4%
SHOWROOM SPACE INCL WC	1210.91 FT²	112.49	14.7%
BULL PEN	1441 FT²	133.87	17.5%
MANAGERS OFFICE	442 FT²	41.06	5%
TOTAL OFFICE AREA INCL WC	2108 FT²	195.84	24.9%
ASSEMBLY REPAIR	220 FT²	20.44	3%
WAREHOUSE	3922 FT²	364.36	47.5%
TOTAL WAREHOUSE INCL STORAGE	4231.5 FT²	393.12	51.4%
TOTAL BUILDING AREA	8231.5 FT²	765	100%

FIXTURE PLAN KEYED NOTES:

- ALL WAREHOUSE CAGING/RACKING SHALL BE SUPPLIED BY CLIENT & INSTALLED BY LANDLORD. LANDLORD TO COORDINATE CABLING FOR ASSOCIATED SECURITY DEVICES.
- ALL FREESTANDING FIXTURES AND MILLWORK, INCLUDING CARE DESK ARE BY OTHERS. LANDLORD IS RESPONSIBLE FOR THE COORDINATION OF THE INSTALLATION OF FREESTANDING ITEMS THAT ARE NOT INCLUDED AS PART OF THEIR SCOPE OF WORK.
- CLIENT TO SUPPLY AND LANDLORD TO INSTALL THE KITCHEN APPLIANCES:
REFRIGERATOR:
FRIGIDAIRE 18.0 CU. FT. TOP FREEZER-FRIGERATOR - WHITE, HINGE ON REFER TO DWG. #FFTR1814TW
DISHWASHER:
FRIGIDAIRE 5 CYCLE DISHWASHER WITH FRONT CONTROLS - WHITE. #FFCD2418UW
MICROWAVE:
WHIRLPOOL 1.6 CU. FT. COUNTERTOP MICROWAVE - WHITE. #YWMG30516HW