

# SUMMARY OF DEVELOPMENT APPLICATIONS CIRCULATED\*



Circulated from June 12 to June 25



2 Development Applications



4340 Total Residential Units



7,439.01 m<sup>2</sup> Total Gross Floor Area Industrial, Commercial or Institutional

## Table of Contents

Summary of Development Applications

From June 12 to June 25

								
Applicant	File Number	Circulation Date	Non-Decision Appeal	Address	Ward	Uses	Total Units	ICI GFA m <sup>2</sup>
<a href="#">CF Markville Nominee Inc. (Justin Cheung)</a>	23-126054 PLAN	22-Jun-23	20-Oct-23	5000 7 Highway E	3	Mixed-Use	4340	N/A
<a href="#">La Tache Crescent Industrial/Office Development</a>	23-122001 SPC	12-Jun-23	12-Aug-23	La Tache Crescent	2	Industrial	N/A	7,439.01

\*official plan amendment, zoning by-law amendment, plan of subdivision, site plan control, condo – defined on final page

# CF Markville Nominee Inc. (Justin Cheung)

## PLAN



### STATISTICS SUMMARY



CF Markville Nominee Inc.(Justin Cheung)



23-126054 PLAN



22-Jun-23



[5000 7 Highway E](#)



[Ward 3](#)



Mixed-Use



4340



N/A



Deanna Schlosser  
ext. 2157



Council/ Committee to  
approve

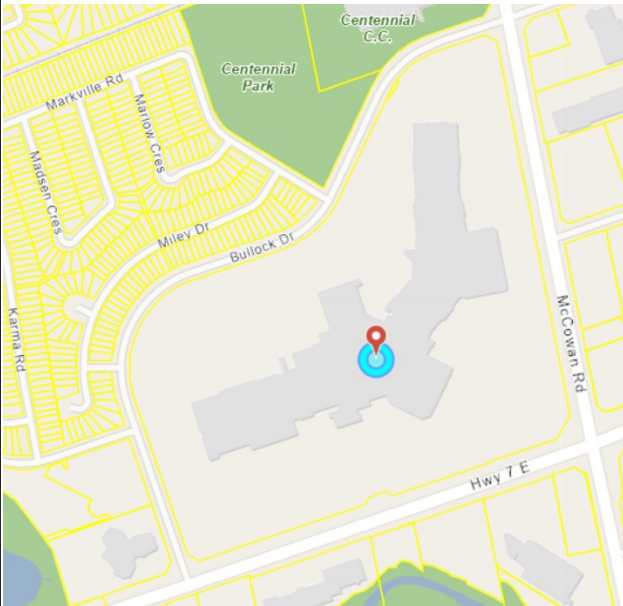

An [ePLAN](#) submission for a Major Official Plan Amendment has been received from CF Markville Nominee Inc.(Justin Cheung) c/o Malone Given Parsons Ltd. (Lincoln Lo) for the subject lands located at 5000 Highway 7 E, Markham. The applicant is proposing a high-density, mixed-use development (while keeping the mall in-situ) consisting of approximately 4,340 residential units, and 11,200 m2 GFA of non-residential and community amenity space, three public parks, various privately owned public spaces, as well as above-grade and underground parking structures.

# La Tache Crescent Industrial/Office Development

## Site Plan Control

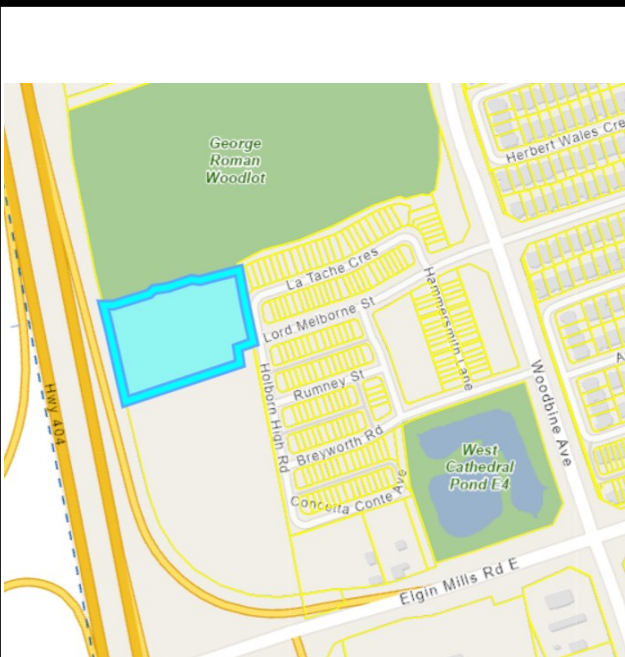

### STATISTICS SUMMARY

	La Tache Crescent Industrial/Office Development
	23-122001 SPC
	12-Jun-23
	<a href="#">La Tache Crescent</a>
	<a href="#">Ward 2</a>
	Industrial
	N/A
	7,439.01
	Clement Messere ext. 2191
	Council/ Committee to approve

A Site Plan Control (SPC) application has been received from 1000139172 ONTARIO INC. c/o Baldassarra Architects Inc. (Milica Zekanovic) for the subject lands located at La Tache Crescent (CON 3 PT LOT 26 RP 65R36783 PART 3). The Owner is proposing the construction of two new industrial buildings with a total of 32 units and a Gross Floor Area (GFA) of 7,439.01 m2 (80,073 sqft). Building A is proposed to be one storey with a mezzanine. Building B is proposed to be two-storeys with a mezzanine component.

# DEFINITION OF APPLICATION TYPES



## **Official Plan Amendment**

The process through which changes are made to the City's Official Plan. A document, containing policies which guide the future development of land in Markham. The Official Plan also includes a framework for establishing regulations and standards for land use and contains policies on how the City will manage growth.

## **Zoning By-Law Amendment**

The process through which the City guides and approves changes to how lands are used for specific purposes. The process also addresses related development standards such as property setbacks, building height, and parking.

## **Plan of Subdivision**

The process through which the City guides and approves the design and layout of building lots and roads (neighborhoods).

## **Site Plan Control**

The process through which the City guides and approves the layout of building elevation, landscape and site circulation.

## **Condo**

The process through which the City guides and approves the development of condominiums.